

SUCTION CUPS / Magic suction cup



P type – Without efficiency valve

Features and Strengths

Excellent for thin plastic bags

Examples of use

Thin plastic bags



Recommended Lifting Force (Max.)

Model	Volume (cm ³)	Lifting Force (Kg) - Perpendicular		
		- 20 kPa	- 60 kPa	- 90 kPa
B1.5/20-P15	1.43	0.3	0.5	0.6
B1.5/20-P17	1.53	0.3	0.6	0.7
B1.5/20-P20	1.83	0.4	0.8	0.9
B1.5/20-P27	2.73	0.8	1.7	2.8
B1.5/20-P32	4.13	1.7	3.4	4.6
B1.5/40-P48	14.4	2.6	5.5	7.2
B1.5/40-P60	21.5	4.6	10.4	14.7
B1.5/60-P72	36.2	6.6	14.9	20.7
B1.5/60-P85	41.5	7.6	16.3	21.9
B2.5/20-P15	3.54	0.3	0.5	0.6
B2.5/20-P17	3.64	0.3	0.6	0.7
B2.5/20-P20	3.94	0.4	0.8	0.9
B2.5/20-P27	4.84	0.8	1.7	2.8
B2.5/20-P32	6.24	1.7	3.4	4.6
B2.5/40-P48	21.8	2.6	5.5	7.2
B2.5/40-P60	28.9	4.6	10.4	14.7
B2.5/60-P72	38.7	6.6	14.9	20.7
B2.5/60-P85	44.1	7.6	16.3	21.9
B4.0/20-P15	3.27	0.3	0.5	0.6
B4.0/20-P17	3.37	0.3	0.6	0.7
B4.0/20-P20	3.67	0.4	0.8	0.9
B4.0/20-P27	4.57	0.8	1.7	2.8
B4.0/20-P32	5.97	1.7	3.4	4.6
B4.0/40-P48	21.8	2.6	5.5	7.2
B4.0/40-P60	28.9	4.6	10.4	14.7
B5.0/20-P15	4.43	0.3	0.5	0.6
B5.0/20-P17	4.53	0.3	0.6	0.7
B5.0/20-P20	4.83	0.4	0.8	0.9
B5.0/20-P27	5.73	0.8	1.7	2.8
B5.0/20-P32	7.13	1.7	3.4	4.6
B5.0/40-P48	34.4	2.6	5.5	7.2
B5.0/40-P60	41.5	4.6	10.4	14.7
B5.0/60-P72	56.5	6.6	14.9	20.7
B5.0/60-P85	61.7	7.6	16.3	21.9
B6.0/20-P15	6.52	0.3	0.5	0.6
B6.0/20-P17	6.62	0.3	0.6	0.7
B6.0/20-P20	6.92	0.4	0.8	0.9
B6.0/20-P27	7.82	0.8	1.7	2.8
B6.0/20-P32	9.22	1.7	3.4	4.6
B6.0/40-P48	41.4	2.6	5.5	7.2
B6.0/40-P60	48.5	4.6	10.4	14.7
B6.0/60-P72	58.9	6.6	14.9	20.7
B6.0/60-P85	61.7	7.6	16.3	21.9

I Material Specifications

Material	Hardness Shore (°)	Color	Temperature (°C)
N6 - NBR (Nitrile)	60	Blue	-20~110
S3 - Silicone	30	Translucent White	-70~200
S5 - Silicone	50	Red	-70~200
W3 - White Silicone	30	Translucent White	-70~200
W5 - White Silicone	50	Translucent White	-70~200
W3(FDA) - White Silicone(FDA)	30	Translucent White	-70~200
W5(FDA) - White Silicone(FDA)	50	Translucent White	-70~200
U6 - Urethane	60	Dark Grey	0~100

* The temperature data is only for suction lip. Please contact us if it is used in over 60°C

** For additional materials, please contact us

I Material Resistance





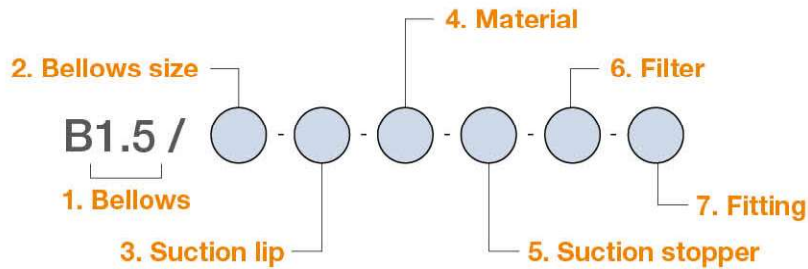

Description	NBR	Silicone	White Silicone	Urethane
Wear Resistance	Excellent	Good	Good	Excellent
Oil	Excellent	Poor	Poor	Excellent
Weather / Ozone	Fair	Excellent	Excellent	Excellent
Alcohol	Good	Good	Good	Fair
Acid	Fair	Poor	Poor	Poor

SUCTION CUPS / Magic suction cup



I Build an Ordering No.



1. Bellows	Description	Symbol
	Top bellows 1.5 folds	B1.5
	Top bellows 2.5 folds	B2.5
	Top bellows 1.5 folds + Middle bellows 2.5 folds	B4.0
	Top bellows 1.5 folds + Middle bellows 3.5 folds	B5.0
	Top bellows 2.5 folds + Middle bellows 3.5 folds	B6.0
2. Bellows size	Description	Symbol
	20mm bellows diameter: For P15, P17, P20, P27 & P32	20
	40mm bellows diameter: For P48 & P60	40
	60mm bellows diameter: For P72 & P85	60
3. Suction lip	Description	Symbol
	P type lip, 15mm diameter	P15
	P type lip, 17mm diameter	P17
	P type lip, 20mm diameter	P20
	P type lip, 27mm diameter	P27
	P type lip, 32mm diameter	P32
	P type lip, 48mm diameter	P48
	P type lip, 60mm diameter	P60
	P type lip, 72mm diameter	P72
	P type lip, 85mm diameter	P85
4. Material	Description	Symbol
	NBR (Nitrile), 60° hardness	N6
	Silicone, 30° hardness	S3
	Silicone, 50° hardness	S5
	White Silicone, 30° hardness	W3
	White Silicone, 50° hardness	W5
	White Silicone, 30° hardness (FDA)	W3(FDA)
	White Silicone, 50° hardness (FDA)	W5(FDA)
	Urethane, 60° hardness	U6
5. Suction stopper	Description	Symbol
	D type	D
6. Filter	Description	Symbol
	No filter	Blank
	Mesh disk filter (200mesh)	F2
7. Fitting	Description	Symbol
	Fitting, G1/8 female	18F
	Fitting, G1/4 female	14F
	Fitting, G1/8 male	18M
	Fitting, G1/4 male	14M
	Fitting, G3/8 male	38M
	Fitting, G3/8 female: Only for 60mm bellow diameter	38F

I Spare Parts – Top Bellows

Part No.	Description
TB1.5/20	Top bellows 1.5 folds for P15, P17, P20, P27 & P32 without efficiency valve
TB1.5/40	Top bellows 1.5 folds for P48 & P60 without efficiency valve
TB1.5/60	Top bellows 1.5 folds for P72 & P85 without efficiency valve
TB2.5/20	Top bellows 2.5 folds for P15, P17, P20, P27 & P32 without efficiency valve
TB2.5/40	Top bellows 2.5 folds for P48 & P60 without efficiency valve
TB2.5/60	Top bellows 2.5 folds for P72 & P85 without efficiency valve

I Spare Parts – Middle Bellows

Part No.	Description	Part No.	Description
MB2.5/20	Middle bellows 2.5 folds for P15, P17, P20, P27 & P32	MB3.5/20	Middle bellows 3.5 folds for P15, P17, P20, P27 & P32
MB2.5/40	Middle bellows 2.5 folds for P48 & P60	MB3.5/40	Middle bellows 3.5 folds for P48 & P60
		MB3.5/60	Middle bellows 3.5 folds for P72 & P85

I Spare Parts – Suction Stoppers

Part No.	Description	Part No.	Description
MS20-D	Stopper D type for P15, P17, P20, P27 & P32	MS60-D	Stopper D type for P72 & P85
MS40-D	Stopper D type for P48 & P60		

I Spare Parts – Filters

Part No.	Description
VTFE20	Mesh disk filter (200mesh) for 20mm bellows diameter
VTFE40	Mesh disk filter (200mesh) for 40mm bellows diameter
VTFE60	Mesh disk filter (200mesh) for 60mm bellows diameter

I Spare Parts – Suction Lips

Part No.	Description	Part No.	Description
P15-N6	P type - 15mm diameter, NBR, 60° hardness	P15-W5	P type - 15mm diameter, White Silicone, 50° hardness
P17-N6	P type - 17mm diameter, NBR, 60° hardness	P17-W5	P type - 17mm diameter, White Silicone, 50° hardness
P20-N6	P type - 20mm diameter, NBR, 60° hardness	P20-W5	P type - 20mm diameter, White Silicone, 50° hardness
P27-N6	P type - 27mm diameter, NBR, 60° hardness	P27-W5	P type - 27mm diameter, White Silicone, 50° hardness
P32-N6	P type - 32mm diameter, NBR, 60° hardness	P32-W5	P type - 32mm diameter, White Silicone, 50° hardness
P48-N6	P type - 48mm diameter, NBR, 60° hardness	P48-W5	P type - 48mm diameter, White Silicone, 50° hardness
P60-N6	P type - 60mm diameter, NBR, 60° hardness	P60-W5	P type - 60mm diameter, White Silicone, 50° hardness
P72-N6	P type - 72mm diameter, NBR, 60° hardness	P72-W5	P type - 72mm diameter, White Silicone, 50° hardness
P85-N6	P type - 85mm diameter, NBR, 60° hardness	P85-W5	P type - 85mm diameter, White Silicone, 50° hardness
P15-S3	P type - 15mm diameter, Silicone, 30° hardness	P15-W3(FDA)	P type - 15mm diameter, White Silicone, 30° hardness (FDA)
P17-S3	P type - 17mm diameter, Silicone, 30° hardness	P17-W3(FDA)	P type - 17mm diameter, White Silicone, 30° hardness (FDA)
P20-S3	P type - 20mm diameter, Silicone, 30° hardness	P20-W3(FDA)	P type - 20mm diameter, White Silicone, 30° hardness (FDA)
P27-S3	P type - 27mm diameter, Silicone, 30° hardness	P27-W3(FDA)	P type - 27mm diameter, White Silicone, 30° hardness (FDA)
P32-S3	P type - 32mm diameter, Silicone, 30° hardness	P32-W3(FDA)	P type - 32mm diameter, White Silicone, 30° hardness (FDA)
P48-S3	P type - 48mm diameter, Silicone, 30° hardness	P48-W3(FDA)	P type - 48mm diameter, White Silicone, 30° hardness (FDA)
P60-S3	P type - 60mm diameter, Silicone, 30° hardness	P60-W3(FDA)	P type - 60mm diameter, White Silicone, 30° hardness (FDA)
P72-S3	P type - 72mm diameter, Silicone, 30° hardness	P72-W3(FDA)	P type - 72mm diameter, White Silicone, 30° hardness (FDA)
P85-S3	P type - 85mm diameter, Silicone, 30° hardness	P85-W3(FDA)	P type - 85mm diameter, White Silicone, 30° hardness (FDA)
P15-S5	P type - 15mm diameter, Silicone, 50° hardness	P15-W5(FDA)	P type - 15mm diameter, White Silicone, 50° hardness (FDA)
P17-S5	P type - 17mm diameter, Silicone, 50° hardness	P17-W5(FDA)	P type - 17mm diameter, White Silicone, 50° hardness (FDA)
P20-S5	P type - 20mm diameter, Silicone, 50° hardness	P20-W5(FDA)	P type - 20mm diameter, White Silicone, 50° hardness (FDA)
P27-S5	P type - 27mm diameter, Silicone, 50° hardness	P27-W5(FDA)	P type - 27mm diameter, White Silicone, 50° hardness (FDA)
P32-S5	P type - 32mm diameter, Silicone, 50° hardness	P32-W5(FDA)	P type - 32mm diameter, White Silicone, 50° hardness (FDA)
P48-S5	P type - 48mm diameter, Silicone, 50° hardness	P48-W5(FDA)	P type - 48mm diameter, White Silicone, 50° hardness (FDA)
P60-S5	P type - 60mm diameter, Silicone, 50° hardness	P60-W5(FDA)	P type - 60mm diameter, White Silicone, 50° hardness (FDA)
P72-S5	P type - 72mm diameter, Silicone, 50° hardness	P72-W5(FDA)	P type - 72mm diameter, White Silicone, 50° hardness (FDA)
P85-S5	P type - 85mm diameter, Silicone, 50° hardness	P85-W5(FDA)	P type - 85mm diameter, White Silicone, 50° hardness (FDA)
P15-W3	P type - 15mm diameter, White Silicone, 30° hardness	P15-U6	P type - 15mm diameter, Urethane, 60° hardness
P17-W3	P type - 17mm diameter, White Silicone, 30° hardness	P17-U6	P type - 17mm diameter, Urethane, 60° hardness
P20-W3	P type - 20mm diameter, White Silicone, 30° hardness	P20-U6	P type - 20mm diameter, Urethane, 60° hardness
P27-W3	P type - 27mm diameter, White Silicone, 30° hardness	P27-U6	P type - 27mm diameter, Urethane, 60° hardness
P32-W3	P type - 32mm diameter, White Silicone, 30° hardness	P32-U6	P type - 32mm diameter, Urethane, 60° hardness
P48-W3	P type - 48mm diameter, White Silicone, 30° hardness	P48-U6	P type - 48mm diameter, Urethane, 60° hardness
P60-W3	P type - 60mm diameter, White Silicone, 30° hardness	P60-U6	P type - 60mm diameter, Urethane, 60° hardness
P72-W3	P type - 72mm diameter, White Silicone, 30° hardness	P72-U6	P type - 72mm diameter, Urethane, 60° hardness
P85-W3	P type - 85mm diameter, White Silicone, 30° hardness	P85-U6	P type - 85mm diameter, Urethane, 60° hardness

I Spare Parts – Fittings

Part No. (Code No.)	Fitting size	Description
350 003 1101	18F	Fitting, G1/8 female for 20mm bellows diameter
350 003 1501	14F	Fitting, G1/4 female for 20mm bellows diameter
350 003 1201	18M	Fitting, G1/8 male for 20mm bellows diameter
350 003 1301	14M	Fitting, G1/4 male for 20mm bellows diameter
350 003 1401	38M	Fitting, G3/8 male for 20mm bellows diameter
350 003 1102	18F	Fitting, G1/8 female for 40mm bellows diameter
350 003 1502	14F	Fitting, G1/4 female for 40mm bellows diameter
350 003 1202	18M	Fitting, G1/8 male for 40mm bellows diameter
350 003 1302	14M	Fitting, G1/4 male for 40mm bellows diameter
350 003 1402	38M	Fitting, G3/8 male for 40mm bellows diameter
350 003 1107	18F	Fitting, G1/8 female for 60mm bellows diameter
350 003 1307	14M	Fitting, G1/4 male for 60mm bellows diameter
350 003 1407	38M	Fitting, G3/8 male for 60mm bellows diameter
350 003 1707	38F	Fitting, G3/8 female for 60mm bellows diameter

SUCTION CUPS / Magic suction cup



Dimensional Data

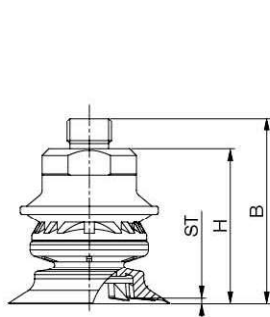

[B1.5 / 20 & 40 & 60 series]

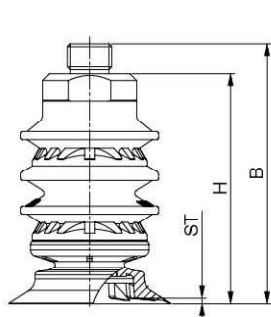

[B4.0 / 20 & 40 & 60 series]

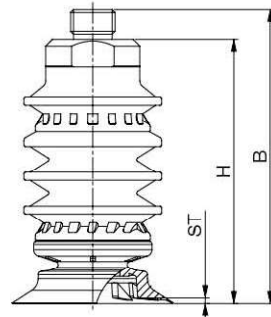

[B5.0 / 20 & 40 & 60 series]

Fitting
18F
18M
14F
14M
38F
38M

[Unit : mm]

Model	Ø A	G	ST	H *	B *
B 1.5/20 – P15	15.5	Female thread : 1/8", 1/4", 3/8" Male thread : 1/8", 1/4", 3/8"	0.8	28.1	37.1
B 1.5/20 – P17	17		0.9	28.5	37.5
B 1.5/20 – P20	20		0.9	29.4	38.4
B 1.5/20 – P27	27		1.4	30.4	39.4
B 1.5/20 – P32	34		1.5	32.8	41.8
B 4.0/20 – P15	15.5		0.8	38.9	47.9
B 4.0/20 – P17	17		0.9	39.3	48.3
B 4.0/20 – P20	20		0.9	40.2	49.2
B 4.0/20 – P27	27		1.4	41.2	50.2
B 4.0/20 – P32	34		1.5	43.6	52.6
B 5.0/20 – P15	15.5		0.8	43.9	52.9
B 5.0/20 – P17	17		0.9	44.3	53.3
B 5.0/20 – P20	20		0.9	45.2	54.2
B 5.0/20 – P27	27		1.4	46.2	55.2
B 5.0/20 – P32	34		1.5	48.6	57.6
B 1.5/40 – P48	48		1.7	46.0	55.0
B 1.5/40 – P60	60		2.8	49.0	58.0
B 4.0/40 – P48	48		1.7	68.4	77.4
B 4.0/40 – P60	60		2.8	71.4	80.4
B 5.0/40 – P48	48		1.7	78.3	87.3
B 5.0/40 – P60	60	2.8	81.3	90.3	
B 1.5/60 – P72	72	3.0	54.2	63.2	
B 1.5/60 – P85	85	4.0	56.2	65.2	
B 5.0/60 – P72	72	3.0	100.7	109.7	
B 5.0/60 – P85	85	4.0	102.7	111.7	

* Dimension "H" and "B" is measured with 14M fitting option

Dimensional Data

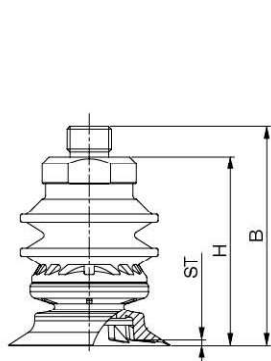

[B2.5 / 20 & 40 & 60 series]

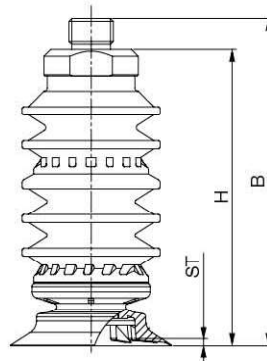

[B6.0 / 20 & 40 & 60 series]

Fitting
18F
18M
14F
14M
38F
38M

[Unit : mm]

Model	Ø A	G	ST	H *	B *
B 2.5/20 – P15	15.5	Female thread : 1/8", 1/4", 3/8" Male thread : 1/8", 1/4", 3/8"	0.8	36.1	45.1
B 2.5/20 – P17	17		0.9	36.5	45.5
B 2.5/20 – P20	20		0.9	37.4	46.4
B 2.5/20 – P27	27		1.4	38.4	47.4
B 2.5/20 – P32	34		1.5	40.8	49.8
B 6.0/20 – P15	15.5		0.8	51.9	60.9
B 6.0/20 – P17	17		0.9	52.3	61.3
B 6.0/20 – P20	20		0.9	53.2	62.2
B 6.0/20 – P27	27		1.4	54.2	63.2
B 6.0/20 – P32	34		1.5	56.6	65.6
B 2.5/40 – P48	48		1.7	56.0	65.0
B 2.5/40 – P60	60		2.8	59.0	68.0
B 6.0/40 – P48	48		1.7	88.3	97.3
B 6.0/40 – P60	60		2.8	91.3	100.3
B 2.5/60 – P72	72		3.0	68.7	77.7
B 2.5/60 – P85	85		4.0	70.7	79.7
B 6.0/60 – P72	72		3.0	115.2	124.2
B 6.0/60 – P85	85		4.0	117.2	126.2

* Dimension "H" and "B" is measured with 14M fitting option



P type – With efficiency valve (EB type)

Features and Strengths

Excellent for thin plastic bags

Examples of use

Thin plastic bags



Recommended Lifting Force (Max.)

Model	Volume (cm ³)	Lifting Force (Kg) - Perpendicular		
		- 20 kPa	- 60 kPa	- 90 kPa
EB1.5/20-P15	2.2	0.3	0.5	0.6
EB1.5/20-P17	2.3	0.3	0.6	0.7
EB1.5/20-P20	2.6	0.4	0.8	0.9
EB1.5/20-P27	3.5	0.8	1.7	2.8
EB1.5/20-P32	4.9	1.7	3.4	4.6
EB1.5/40-P48	16.1	2.6	5.5	7.2
EB1.5/40-P60	23.2	4.6	10.4	14.7
EB4.0/20-P15	4.0	0.3	0.5	0.6
EB4.0/20-P17	4.1	0.3	0.6	0.7
EB4.0/20-P20	4.4	0.4	0.8	0.9
EB4.0/20-P27	5.3	0.8	1.7	2.8
EB4.0/20-P32	6.7	1.7	3.4	4.6
EB4.0/40-P48	29.4	2.6	5.5	7.2
EB4.0/40-P60	36.5	4.6	10.4	14.7
EB5.0/20-P15	5.19	0.3	0.5	0.6
EB5.0/20-P17	5.29	0.3	0.6	0.7
EB5.0/20-P20	5.59	0.4	0.8	0.9
EB5.0/20-P27	6.49	0.8	1.7	2.8
EB5.0/20-P32	7.89	1.7	3.4	4.6
EB5.0/40-P48	36.2	2.6	5.5	7.2
EB5.0/40-P60	43.3	4.6	10.4	14.7

I Material Specifications

Material	Hardness Shore (°)	Color	Temperature (°C)
N6 - NBR (Nitrile)	60	Blue	-20~110
S3 - Silicone	30	Translucent White	-70~200
S5 - Silicone	50	Red	-70~200
W3 - White Silicone	30	Translucent White	-70~200
W5 - White Silicone	50	Translucent White	-70~200
W3(FDA) - White Silicone(FDA)	30	Translucent White	-70~200
W5(FDA) - White Silicone(FDA)	50	Translucent White	-70~200
U6 - Urethane	60	Dark Grey	0~100

* The temperature data is only for suction lip. Please contact us if it is used in over 60°C

** For additional materials, please contact us

I Material Resistance





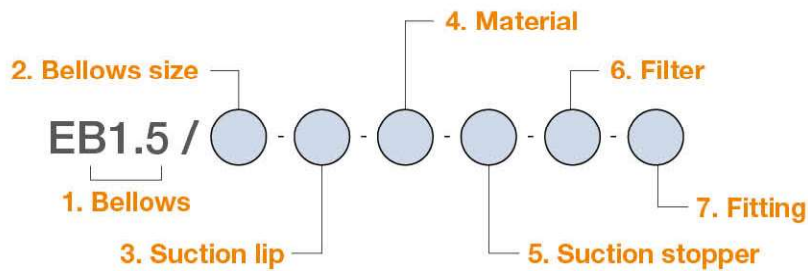

Description	NBR	Silicone	White Silicone	Urethane
Wear Resistance	Excellent	Good	Good	Excellent
Oil	Excellent	Poor	Poor	Excellent
Weather / Ozone	Fair	Excellent	Excellent	Excellent
Alcohol	Good	Good	Good	Fair
Acid	Fair	Poor	Poor	Poor

SUCTION CUPS / Magic suction cup



I Build an Ordering No.



1. Bellows	Description	Symbol
	Top bellows 1.5 folds with efficiency valve	EB1.5
	Top bellows 1.5 folds with efficiency valve + Middle bellows 2.5 folds	EB4.0
	Top bellows 1.5 folds with efficiency valve + Middle bellows 3.5 folds	EB5.0
2. Bellows size	Description	Symbol
	20mm bellows diameter: For P15, P17, P20, P27 & P32	20
	40mm bellows diameter: For P48 & P60	40
3. Suction lip	Description	Symbol
	P type lip, 15mm diameter	P15
	P type lip, 17mm diameter	P17
	P type lip, 20mm diameter	P20
	P type lip, 27mm diameter	P27
	P type lip, 32mm diameter	P32
	P type lip, 48mm diameter	P48
	P type lip, 60mm diameter	P60
4. Material	Description	Symbol
	NBR (Nitrile), 60° hardness	N6
	Silicone, 30° hardness	S3
	Silicone, 50° hardness	S5
	White Silicone, 30° hardness	W3
	White Silicone, 50° hardness	W5
	White Silicone, 30° hardness (FDA)	W3(FDA)
	White Silicone, 50° hardness (FDA)	W5(FDA)
	Urethane, 60° hardness	U6
5. Suction stopper	Description	Symbol
	D type	D
6. Filter	Description	Symbol
	No filter	Blank
	Mesh disk filter (200mesh)	F2
7. Fitting	Description	Symbol
	Fitting, G1/8 female	18F
	Fitting, G1/4 female	14F
	Fitting, G1/8 male	18M
	Fitting, G1/4 male	14M
	Fitting, G3/8 male	38M

I Spare Parts – Top Bellows

Part No.	Description
EB1.5/20	Top bellows 1.5 folds for P15, P17, P20, P27 & P32 with efficiency valve
EB1.5/40	Top bellows 1.5 folds for P48 & P60 with efficiency valve

I Spare Parts – Middle Bellows

Part No.	Description	Part No.	Description
MB2.5/20	Middle bellows 2.5 folds for P15, P17, P20, P27 & P32	MB3.5/20	Middle bellows 3.5 folds for P15, P17, P20, P27 & P32
MB2.5/40	Middle bellows 2.5 folds for P48 & P60	MB3.5/40	Middle bellows 3.5 folds for P48 & P60

I Spare Parts – Suction Stoppers

Part No.	Description	Part No.	Description
MS20-D	Stopper D type for P15, P17, P20, P27 & P32	MS40-D	Stopper D type for P48 & P60

I Spare Parts – Filters

Part No.	Description
VTFE20	Mesh disk filter (200mesh) for 20mm bellows diameter
VTFE40	Mesh disk filter (200mesh) for 40mm bellows diameter

I Spare Parts – Suction Lips

Part No.	Description	Part No.	Description
P15-N6	P type - 15mm diameter, NBR, 60° hardness	P15-W5	P type - 15mm diameter, White Silicone, 50° hardness
P17-N6	P type - 17mm diameter, NBR, 60° hardness	P17-W5	P type - 17mm diameter, White Silicone, 50° hardness
P20-N6	P type - 20mm diameter, NBR, 60° hardness	P20-W5	P type - 20mm diameter, White Silicone, 50° hardness
P27-N6	P type - 27mm diameter, NBR, 60° hardness	P27-W5	P type - 27mm diameter, White Silicone, 50° hardness
P32-N6	P type - 32mm diameter, NBR, 60° hardness	P32-W5	P type - 32mm diameter, White Silicone, 50° hardness
P48-N6	P type - 48mm diameter, NBR, 60° hardness	P48-W5	P type - 48mm diameter, White Silicone, 50° hardness
P60-N6	P type - 60mm diameter, NBR, 60° hardness	P60-W5	P type - 60mm diameter, White Silicone, 50° hardness
P15-S3	P type - 15mm diameter, Silicone, 30° hardness	P15-W3(FDA)	P type - 15mm diameter, White Silicone, 30° hardness (FDA)
P17-S3	P type - 17mm diameter, Silicone, 30° hardness	P17-W3(FDA)	P type - 17mm diameter, White Silicone, 30° hardness (FDA)
P20-S3	P type - 20mm diameter, Silicone, 30° hardness	P20-W3(FDA)	P type - 20mm diameter, White Silicone, 30° hardness (FDA)
P27-S3	P type - 27mm diameter, Silicone, 30° hardness	P27-W3(FDA)	P type - 27mm diameter, White Silicone, 30° hardness (FDA)
P32-S3	P type - 32mm diameter, Silicone, 30° hardness	P32-W3(FDA)	P type - 32mm diameter, White Silicone, 30° hardness (FDA)
P48-S3	P type - 48mm diameter, Silicone, 30° hardness	P48-W3(FDA)	P type - 48mm diameter, White Silicone, 30° hardness (FDA)
P60-S3	P type - 60mm diameter, Silicone, 30° hardness	P60-W3(FDA)	P type - 60mm diameter, White Silicone, 30° hardness (FDA)
P15-S5	P type - 15mm diameter, Silicone, 50° hardness	P15-W5(FDA)	P type - 15mm diameter, White Silicone, 50° hardness (FDA)
P17-S5	P type - 17mm diameter, Silicone, 50° hardness	P17-W5(FDA)	P type - 17mm diameter, White Silicone, 50° hardness (FDA)
P20-S5	P type - 20mm diameter, Silicone, 50° hardness	P20-W5(FDA)	P type - 20mm diameter, White Silicone, 50° hardness (FDA)
P27-S5	P type - 27mm diameter, Silicone, 50° hardness	P27-W5(FDA)	P type - 27mm diameter, White Silicone, 50° hardness (FDA)
P32-S5	P type - 32mm diameter, Silicone, 50° hardness	P32-W5(FDA)	P type - 32mm diameter, White Silicone, 50° hardness (FDA)
P48-S5	P type - 48mm diameter, Silicone, 50° hardness	P48-W5(FDA)	P type - 48mm diameter, White Silicone, 50° hardness (FDA)
P60-S5	P type - 60mm diameter, Silicone, 50° hardness	P60-W5(FDA)	P type - 60mm diameter, White Silicone, 50° hardness (FDA)
P15-W3	P type - 15mm diameter, White Silicone, 30° hardness	P15-U6	P type - 15mm diameter, Urethane, 60° hardness
P17-W3	P type - 17mm diameter, White Silicone, 30° hardness	P17-U6	P type - 17mm diameter, Urethane, 60° hardness
P20-W3	P type - 20mm diameter, White Silicone, 30° hardness	P20-U6	P type - 20mm diameter, Urethane, 60° hardness
P27-W3	P type - 27mm diameter, White Silicone, 30° hardness	P27-U6	P type - 27mm diameter, Urethane, 60° hardness
P32-W3	P type - 32mm diameter, White Silicone, 30° hardness	P32-U6	P type - 32mm diameter, Urethane, 60° hardness
P48-W3	P type - 48mm diameter, White Silicone, 30° hardness	P48-U6	P type - 48mm diameter, Urethane, 60° hardness
P60-W3	P type - 60mm diameter, White Silicone, 30° hardness	P60-U6	P type - 60mm diameter, Urethane, 60° hardness

I Spare Parts – Fittings

Part No. (Code No.)	Fitting size	Description
350 006 1101	18F	EB type, G1/8 female for 20mm bellows diameter
350 006 1501	14F	EB type, G1/4 female for 20mm bellows diameter
350 006 1201	18M	EB type, G1/8 male for 20mm bellows diameter
350 006 1301	14M	EB type, G1/4 male for 20mm bellows diameter
350 006 1401	38M	EB type, G3/8 male for 20mm bellows diameter
350 006 1102	18F	EB type, G1/8 female for 40mm bellows diameter
350 006 1502	14F	EB type, G1/4 female for 40mm bellows diameter
350 006 1202	18M	EB type, G1/8 male for 40mm bellows diameter
350 006 1302	14M	EB type, G1/4 male for 40mm bellows diameter
350 006 1402	38M	EB type, G3/8 male for 40mm bellows diameter

SUCTION CUPS / Magic suction cup



Dimensional Data

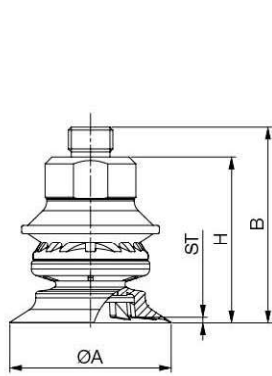

[EB1.5 / 20 & 40 series]

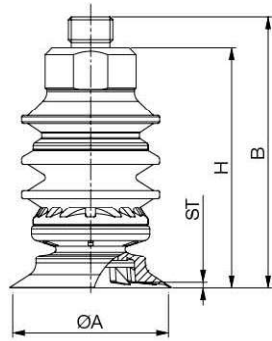

[EB4.0 / 20 & 40 series]

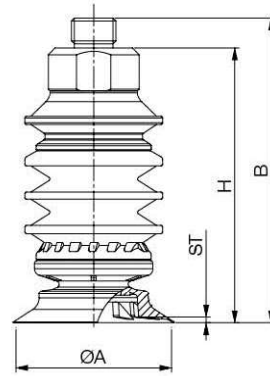

[EB5.0 / 20 & 40 series]

Fitting
18F
18M
14F
14M
38M

[Unit : mm]

Model	Ø A	G	ST	H *	B *	
EB 1.5/20 – P15	15.5	Female thread : 1/8", 1/4"	0.8	28.6	37.6	
EB 1.5/20 – P17	17		0.9	29	38	
EB 1.5/20 – P20	20		0.9	29.9	38.9	
EB 1.5/20 – P27	27		1.4	30.9	39.9	
EB 1.5/20 – P32	34		1.5	33.3	42.3	
EB 4.0/20 – P15	15.5		Male thread : 1/8", 1/4", 3/8"	0.8	39.4	48.4
EB 4.0/20 – P17	17			0.9	39.8	48.8
EB 4.0/20 – P20	20			0.9	40.7	49.7
EB 4.0/20 – P27	27			1.4	41.7	50.7
EB 4.0/20 – P32	34			1.5	44.1	53.1
EB 5.0/20 – P15	15.5			0.8	44.4	53.4
EB 5.0/20 – P17	17			0.9	44.8	53.8
EB 5.0/20 – P20	20			0.9	45.7	54.7
EB 5.0/20 – P27	27			1.4	46.7	55.7
EB 5.0/20 – P32	34			1.5	49.1	58.1
EB 1.5/40 – P48	48		1.7	49.1	58.1	
EB 1.5/40 – P60	60	2.8	52.1	61.1		
EB 4.0/40 – P48	48	1.7	71.5	80.5		
EB 4.0/40 – P60	60	2.8	74.5	83.5		
EB 5.0/40 – P48	48	1.7	81.5	90.5		
EB 5.0/40 – P60	60	2.8	84.5	93.5		

* Dimension "H" and "B" is measured with 14M fitting option